

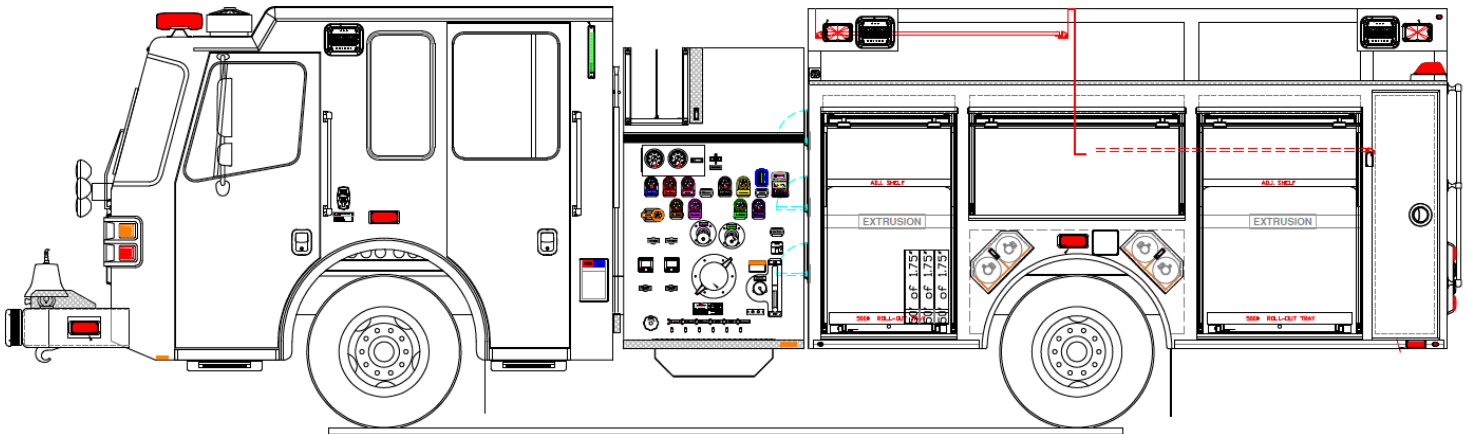

White River Township, Indiana Cinder Custom Pumper

Truck #H7049



CHASSIS

- Ferrara Cinder Extended Medium Cab (62").
- Cummins L9 450HP Engine
- Allison 3000EVS Transmission
- GAWR: Front 20K – Rear 27K
- Heavy-Duty Frame Rail Style Front Bumper
- 188" Wheelbase
- Custom American Flag Cab Grill

BODY FEATURES

- 102" Extruded Aluminum Body
- Rescue Style Compartments on Left and Right Sides
- Low Hosebed Design
- ROM Painted Roll-Up Doors
- Wheelwell SCBA Bottle Storage
- Enclosed Ladder and Suction Storage Beside Tank

ELECTRIC & WARNING

- 73" Federal Navigator Lightbar
- Federal QuadraFlare QL73XF-R Warning Lights
- FireTech Scene Lighting
- Roto-Ray LED Warning Light
- Firecom 5100D Headset System

PUMP & PLUMBING

- Side-Mount Extruded Pump Module
- Backboard Storage Behind Crosslays
- Hale 1,750 GPM QMAX-XS Pump
- 5" Front Suction
- Stainless Steel Plumbing
- TFT Hurricane Electronic Deck Gun
- 1,000-Gallon L-Shaped Tank

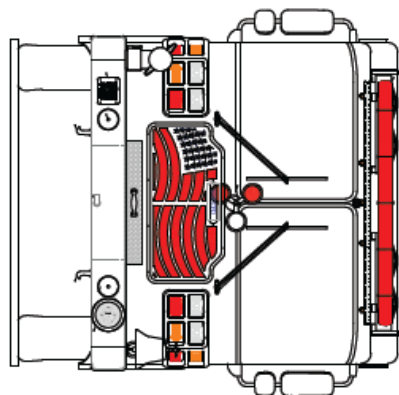
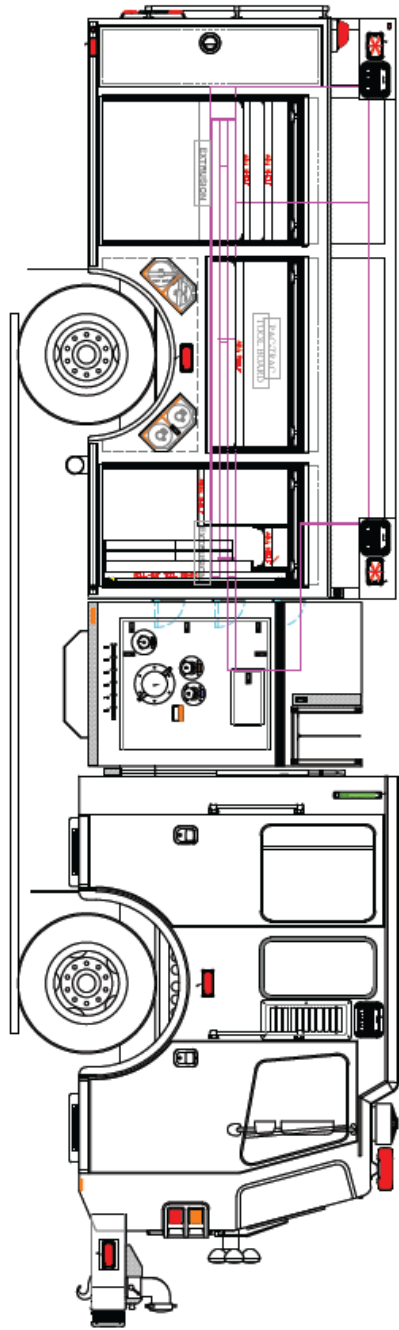

COMPARTMENT DIMENSIONS	
COMP. / OPENING	INTERIOR
L1/H1	33.5W X 55.25H
L2/H2	55.5W X 23.25H
L3/H3	41.5W X 55.25H
L4/H4	16W X 64H
B1	43.5W X 21.25H

IT IS UNLAWFUL TO COPY OR REPRODUCE ANY OR ALL OF THIS DRAWING WITHOUT THE WRITTEN PERMISSION OF FERRARA FIRE APPLIANCE. ANY UNAUTHORIZED REPRODUCTION WILL RESULT IN PROSECUTION TO THE MAXIMUM EXTENT OF THE LAW. DIMENSIONS ARE APPROXIMATE AND ARE SUBJECT TO DEVIATIONS THAT MAY OCCUR ON BE NECESSARY DURING CONSTRUCTION. SOME DETAILS MAY NOT BE SHOWN.

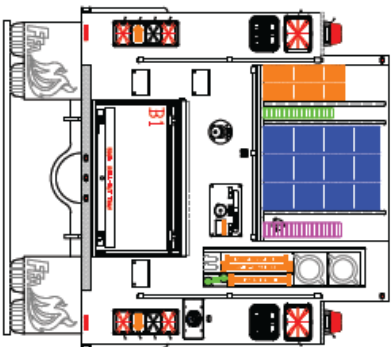
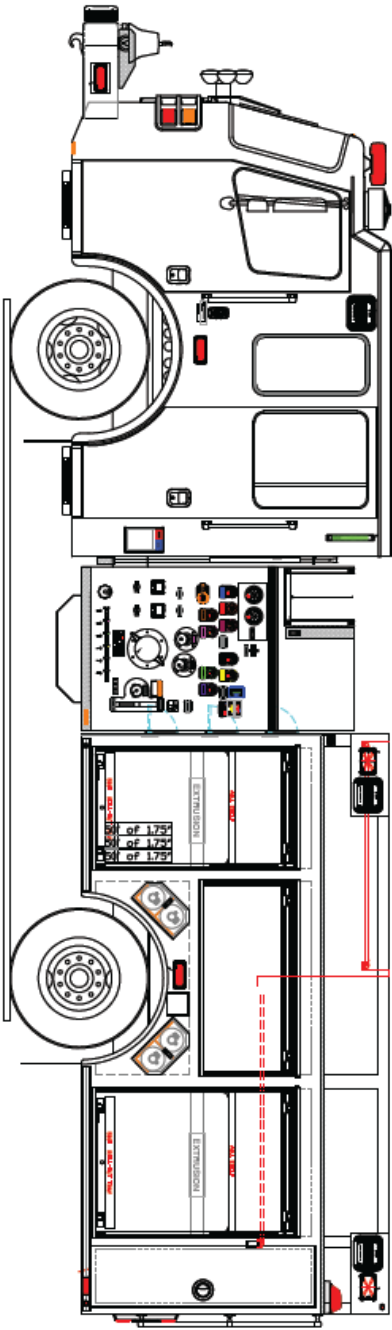
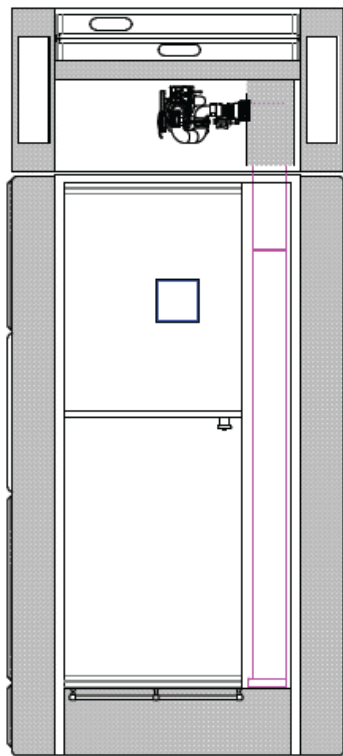

WHITE RIVER TWP.

CICERO, IN

JOB NO.: H7049

1,750 GPM HALE OMAX-3S PUMP

1,000 GALLON WATER TANK