

F-180 CUSTOM QUINT

MODEL #RMA77

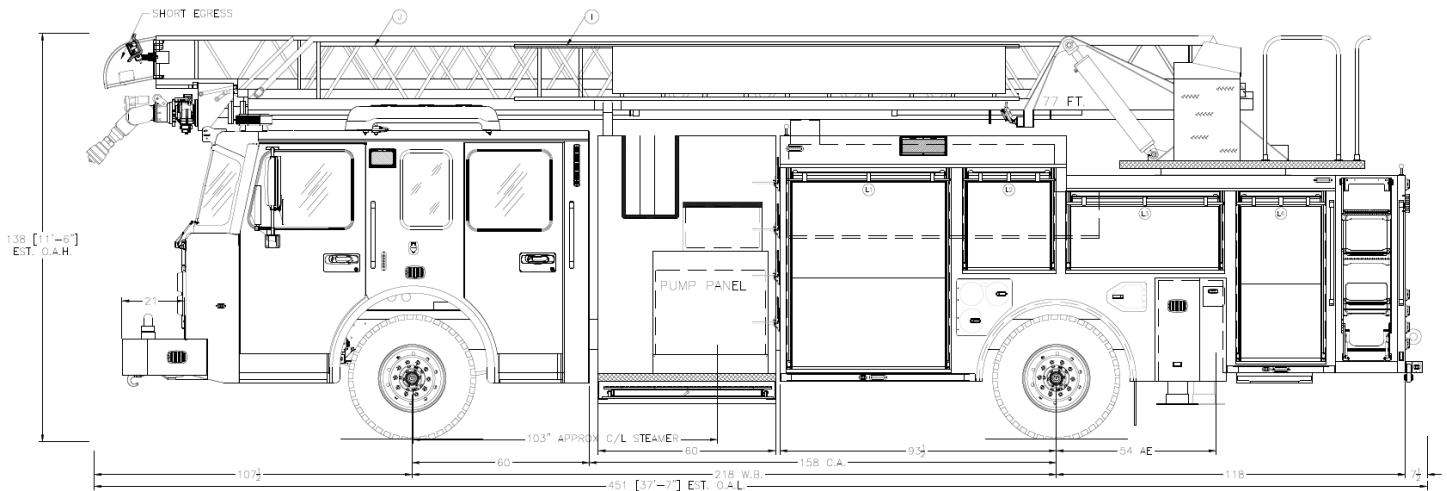

CHASSIS

- Ferrara Invader EMFD Flat Roof
- Seating Capacity 6
- Cummins X10 450 HP Engine
- Allison 4000 EVS Transmission
- Extreme Duty Interior
- FRC OmniPlex 10" Touchscreen Controls
- 12.8" Touchscreen Instrument Cluster
- IMMI 4Front® & RollTek™ Occupant Protection
- Steertek™ NXT Front Suspension
- Roadmaax™ Rear Suspension
- Axles: 23,000 Front, 35,000 Rear
- 21" Front Bumper Extension
- 218" Wheelbase
- Advanced Climate Control
- Rear View Backup Camera w/ Color Display
- Side Scene Lighting
- 45° Cramp Angle
- Michelin Tires
- Severe Duty Front Bumper
- Dual Grover Brand Stutter Air Horns
- Federal Q2B Mechanical Siren

PUMP & PLUMBING

- Waterous CSU 2000 GPM
- FRC InControl Pressure Governor
- 480 Gallons Water / 20 Gallons Foam
- Pre-Connects:
 - (2) 1-3/4" Crosslays
 - (1) 2-1/2" Crosslay
 - (1) 2-1/2" Front Trashline
- Poly Water Tank
- Optional Foam Injection Systems

AERIAL & WATERWAY

- 500lb Tip Load Wet or Dry
- Two H-Style Outriggers Behind Rear Axle w/ 18' Jack Spread
- 75' Vertical Reach, 71.5' Horizontal Reach
- 72° Max Elevation, -6° Min Elevation
- 11'-6" (138") Overall Height
- 4" Waterway Inlet Curbside
- Whelen Scene Lighting at Tip and Base
- TFT Flex RC Monitor w/ 1500 GPM Nozzle
- TFT Valve Under Monitor w/ 2-1/2" Gated Elbow
- Storage for 14' Roof Ladder in Base Section
- Storage for 8' Pike Pole in Fly Section

BODY

- High Strength Aluminum Body
- ROM Series IV Roll-up Doors
- Door Protection Shields
- SCBA Bottle Storage for (8)
- Durable Compartment Finish
- OnScene LED Compartment Lighting
- Whelen LED Lighting Package
- 136' Ladder Storage for 35', 28', (2)16', 10' Attic Ladder, 17' Little Giant, Three Pike Poles, Two D-handle Pike Poles, and Three NY Roof Hook
- Whelen Pioneer Side Scene Lighting
- Optional 6kW Generator
- 30 Cubic Feet Hose Bed Volume
- Rear Directional Light
- Folding Turntable Access Ladder LH Side

