

F-180 CUSTOM PUMPER

MODEL #4115

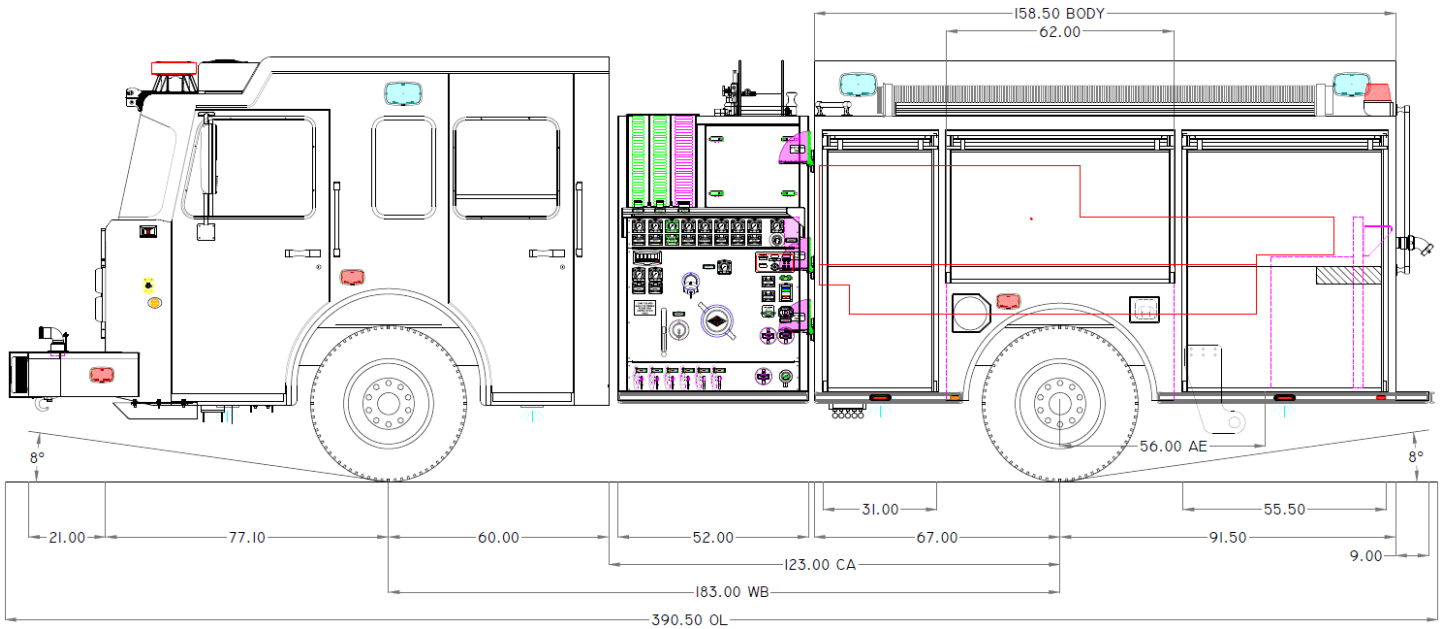

CHASSIS

- Ferrara Invader EMFD 10" Raised Roof
- Seating Capacity 6
- Cummins X10 450HP MHD or HHD Engine
- Extreme Duty Interior
- FRC OmniPlex 10" Touchscreen Controls
- 12.8" Touchscreen Instrument Cluster
- IMMI 4Front® & RollTek™ Occupant Protection
- Steertek™ NXT Front Suspension
- Firemaxx™ Rear Air Suspension
- Axles: 21,500 Front, 27,000 Rear
- 21" Front Bumper Extension
- 183" Wheelbase
- Advanced Climate Control
- Rear View Backup Camera w/ Color Display
- Whelen Front & Side Scene Lighting
- 45° Cramp Angle
- Michelin Tires
- HD Steel Severe Duty Front Bumper
- Dual Grover Brand Stutter Air Horns
- Federal Q2B Mechanical Siren

PUMP & PLUMBING

- Waterous CSU 2000 GPM
- FRC InControl Pressure Governor
- 750 Gallons Water / 20 Gallons Foam
- 5" Front Suction w/ Swivel
- 4" Master Discharge
- Booster Reel
- LH and RH Rear Discharges
- Pre-Connects:
 - (2) 1-3/4" Crosslays
 - (1) 2-1/2" Crosslay
 - (1) 2-1/2" Front Trashline
 - (1) 2-1/2" Hose Bed
- TFT Extenda-Gun on Deluge Riser
- Poly Water Tank

BODY

- Tri-Max™ High Strength Aluminum Body
- Vibra-Torque Body Mounting System
- ROM Series IV Roll-up Doors
- Dual Full-Height LED Compartment Lights
- Door Protection Shields
- SCBA Bottle Storage for (3)
- Durable Compartment Finish
- OnScene LED Compartment Lighting
- Whelen LED Lighting Package
- Ladder Storage for 24', 14', 10' Attic Ladder, Backboard, and Two std Pike Poles
- Intermediate Rear Step w/ Handhold
- Whelen Side Scene Lighting

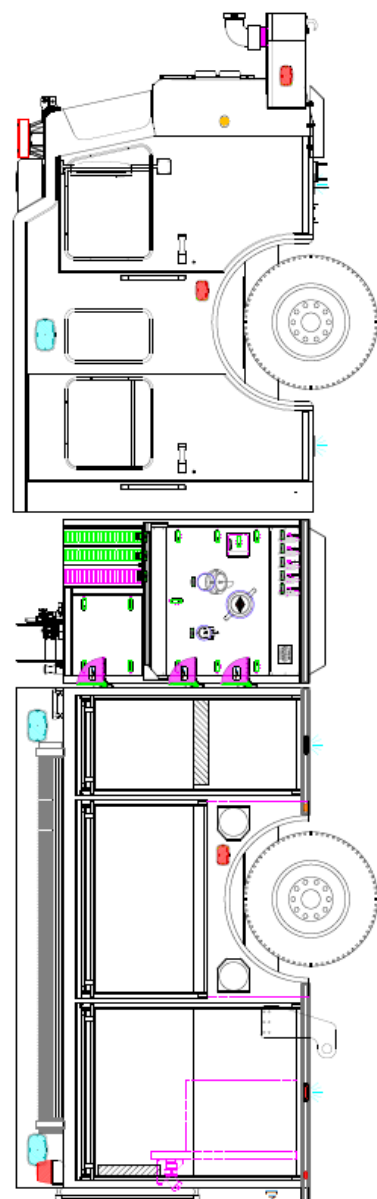
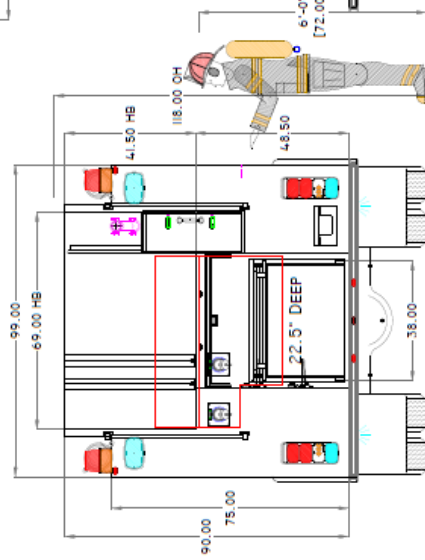
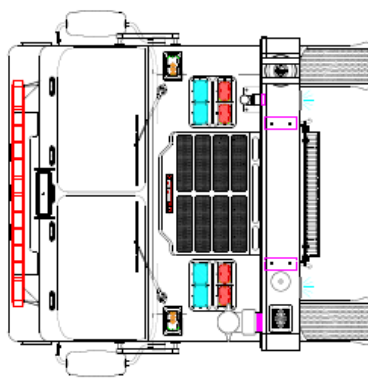
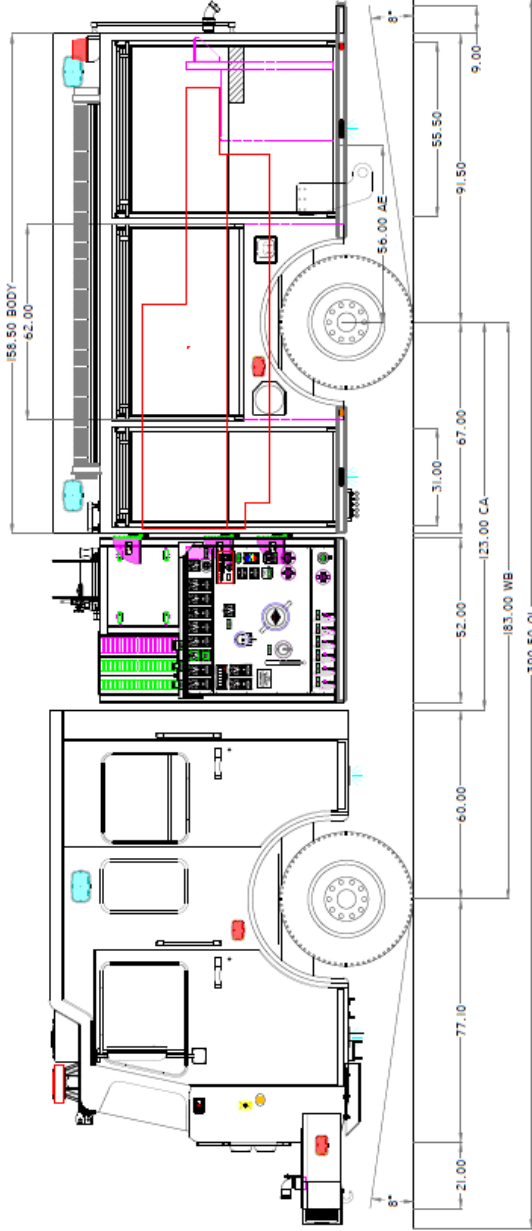
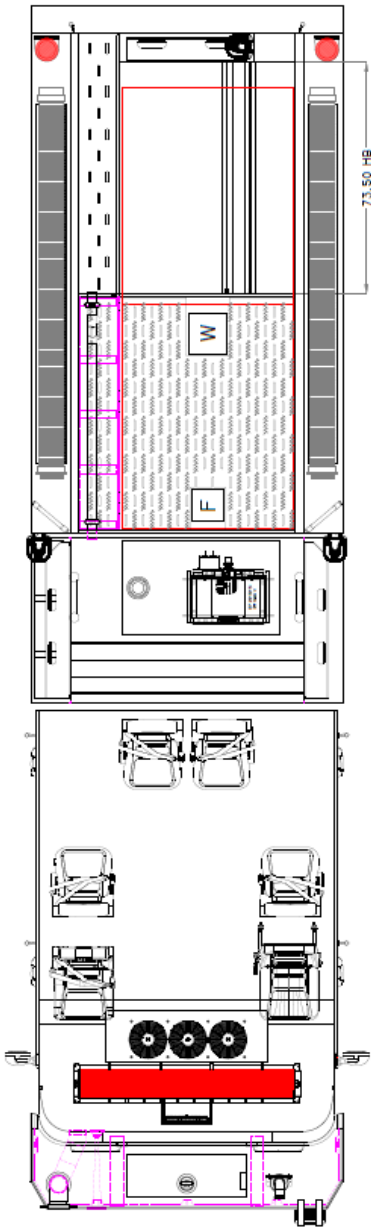

TAKE COMMAND

ferrarafire.com/f-180-rapid-delivery/